

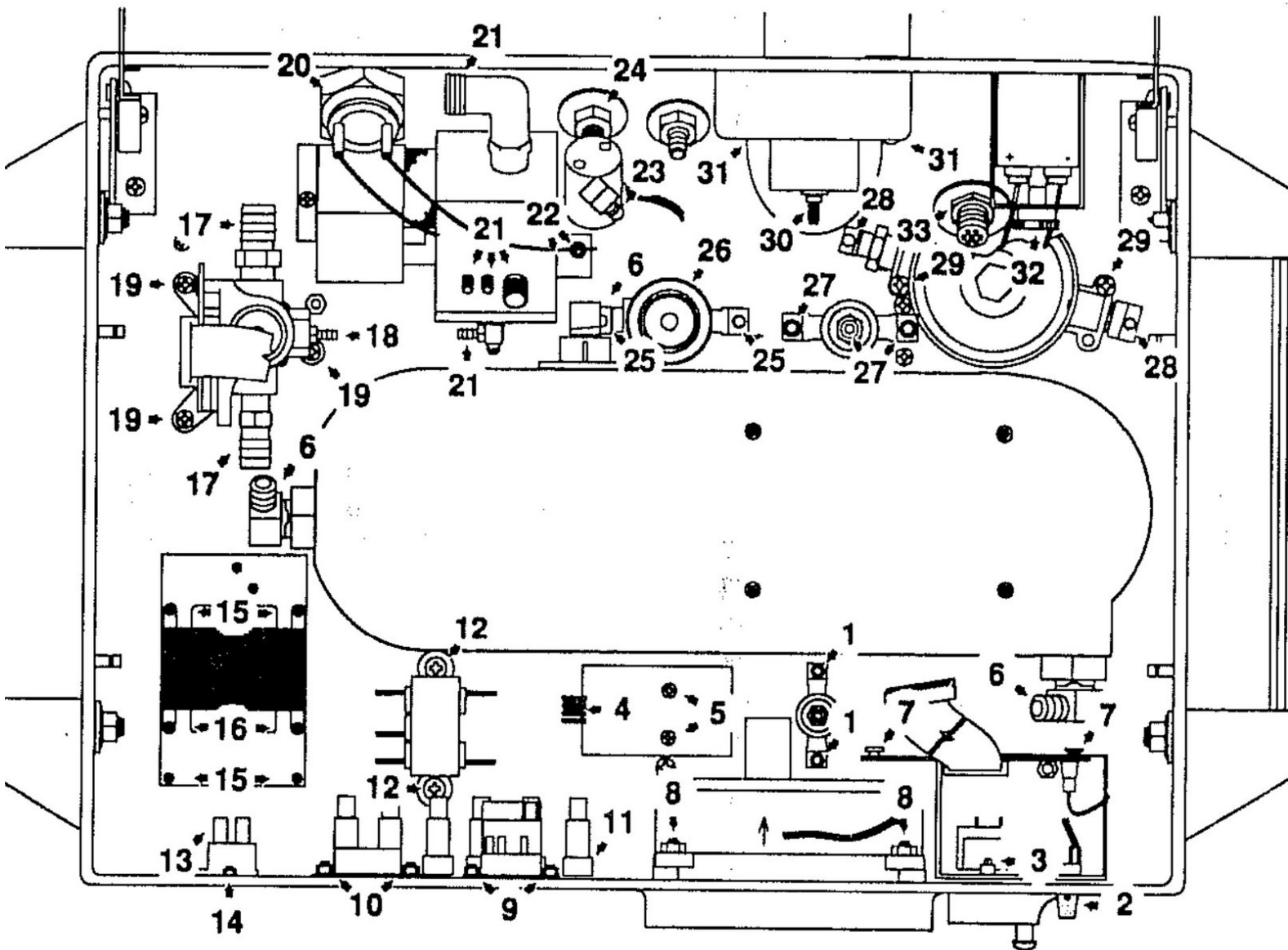

Bear 1000 Power Entry Module Replacement

Use this guide to replace the Power Entry Module in your Bear 1000 ventilator.

Written By: Eli Ferman



INTRODUCTION

This guide will walk you through the process of replacing the Power entry Module in a Bear 1000 Ventilator. Found on page 88 in the full service manual.



TOOLS:

- [flat head & philips screw driver](#) (1)
 - [Large Needle Nose Pliers](#) (1)
 - [Zip Ties](#) (1)
 - [Marker](#) (1)
 - [Allen Wrench 7/32"](#) (1)
-

Step 1 — Air and O2 Blender

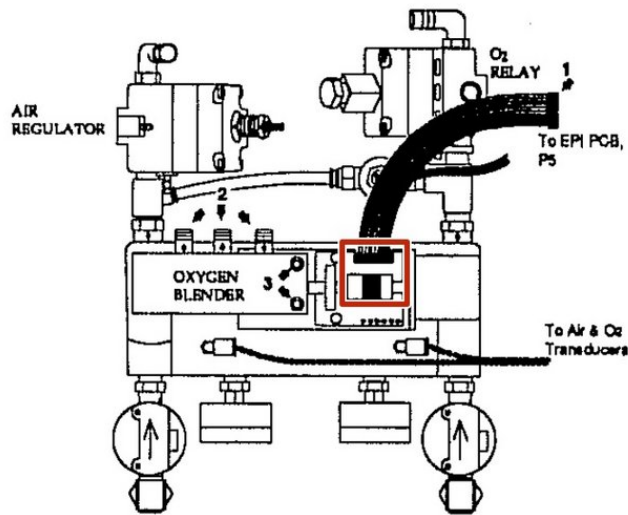

Figure 8-3
Air & O2 Blender

- Remove the ribbon cable at the connection on the oxygen blender control board.

Step 2

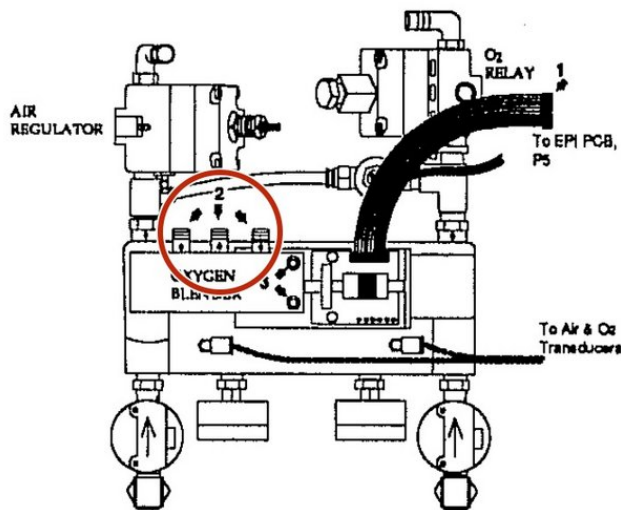

Figure 8-3
Air & O2 Blender

- Mark the plastic hoses attached to the oxygen blender (so you can put them back on the same way) and then remove.

Step 3

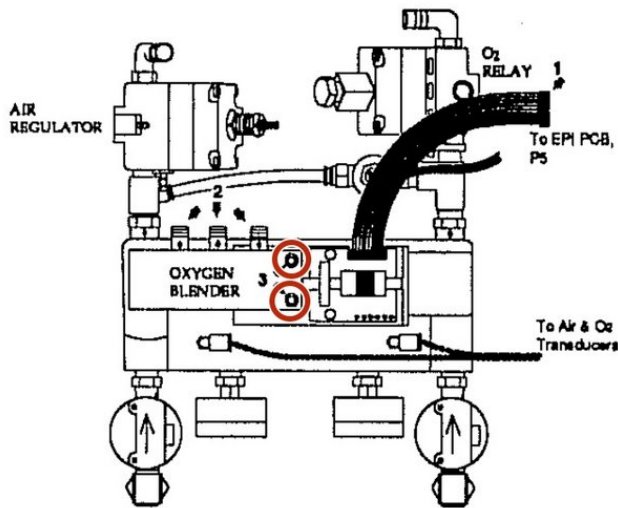

Figure 8-3
Air & O2 Blender

- The air/oxygen blender has two screws close to the control board. Remove them and remove the unit.

Step 4 — Air and O2 Inlet Manifold

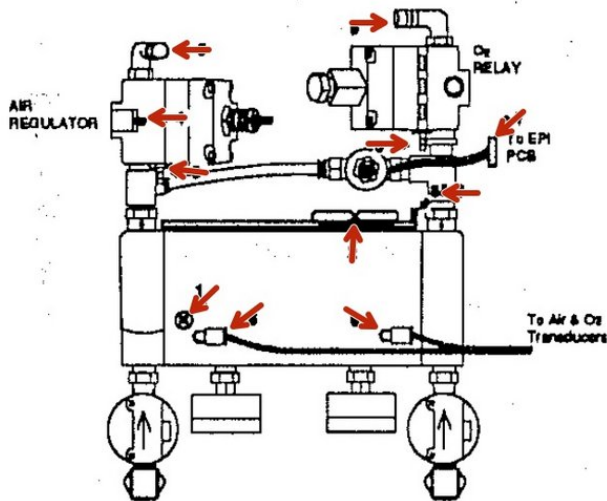

Figure 8-4
Inlet Manifold

- Remove the pneumatic and electrical connections labeled.

Step 5



- Remove the water trap bowls on the rear of the unit.

Step 6

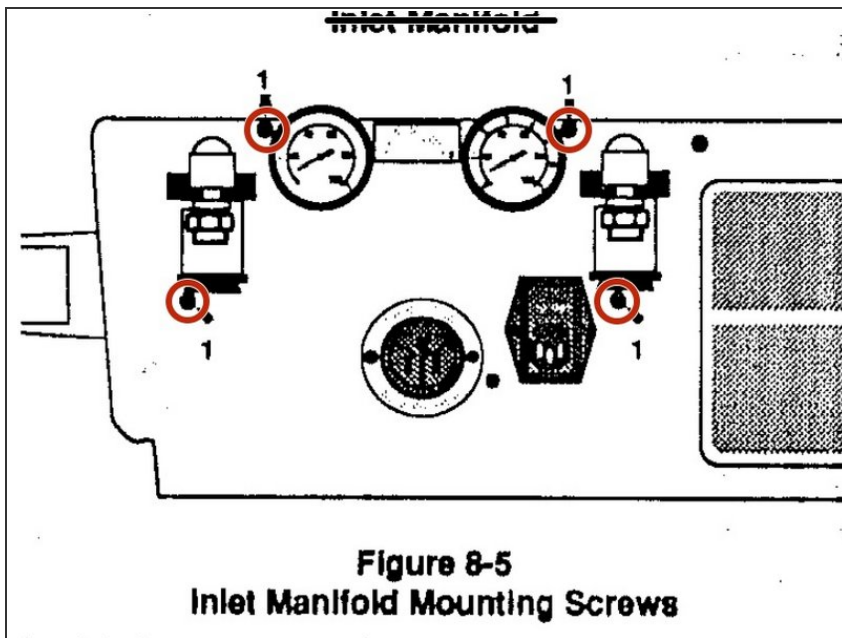

- Remove the four screws and remove the manifold.

Step 7



- Remove the two screws holding the power supply to the manifold.

Step 8 — Power Entry Module



- Mark or label the 6 faston connections as to position and remove

Step 9



- Mark or label the two wires going to the power switch and remove at the power switch end

Step 10



- Using an allen wrench, remove the power cord retaining bracket.

Step 11

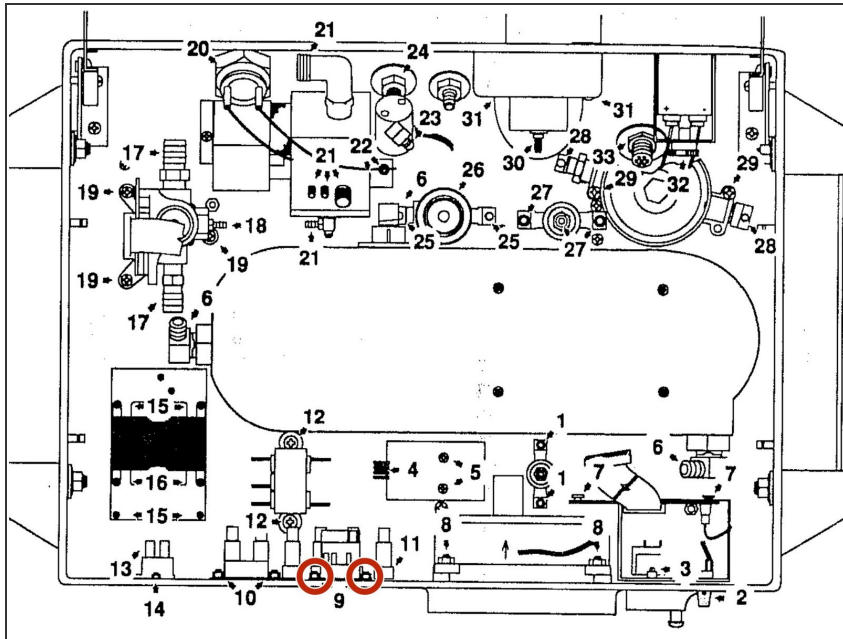

- Using an allen wrench, remove the mounting screws and nuts from the Power Entry Module.

Step 12



- After removing the heat shrink tubing, unsolder the two lower wires from the Power Entry Module, noting locations.

Step 13



- Solder the wires to the replacement module, covering the joints with heat shrink tubing.

Step 14



- Transfer the voltage selector drum from the original module to the replacement and reinstall.

To reassemble your device, follow these instructions in reverse order.