

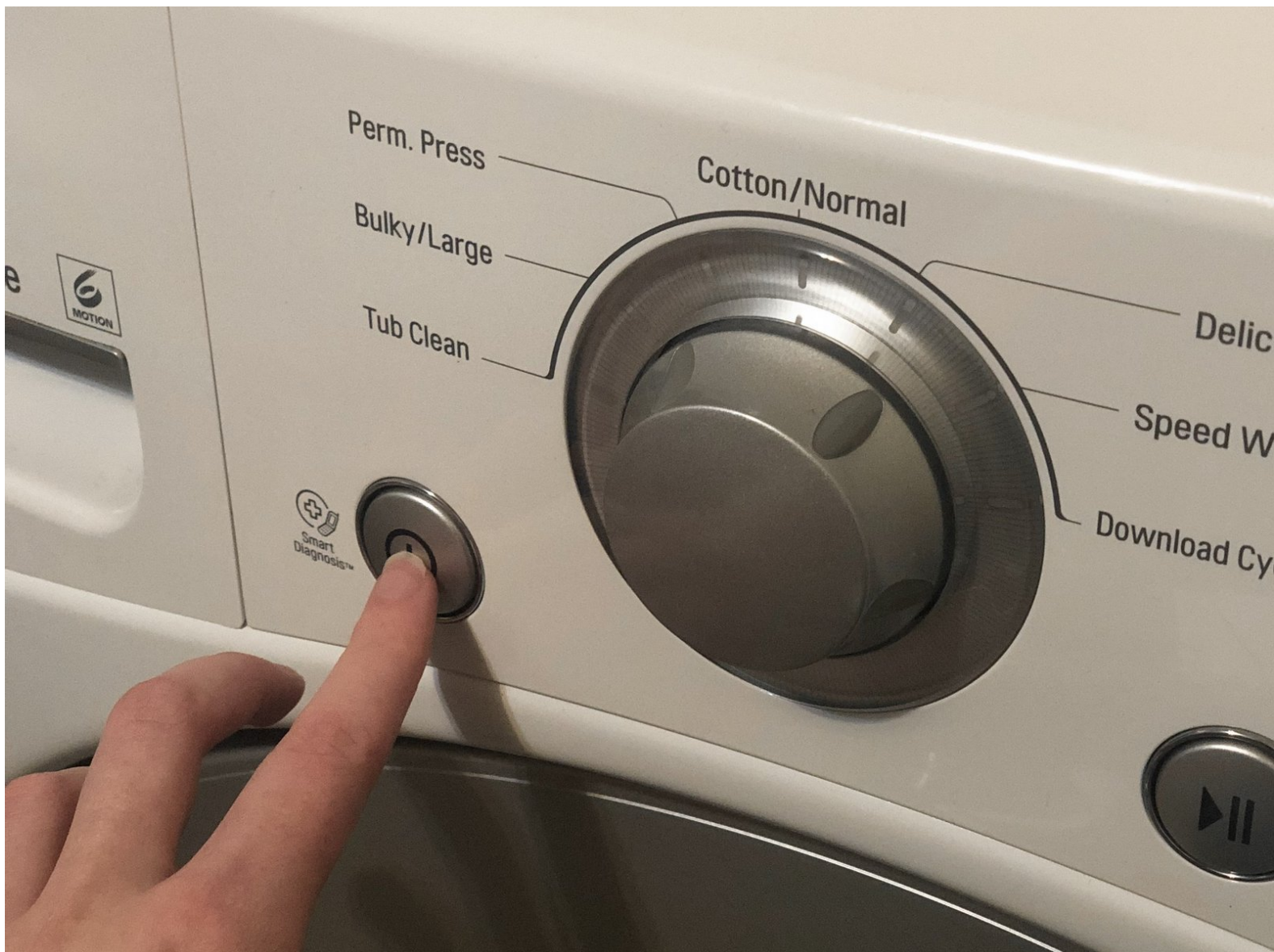

How to Drain and Clean the Drain Filter on the LG WM3170CW

This guide will show you how to drain and clean...

Written By: Elise Graham



INTRODUCTION

This guide will show you how to drain and clean the drain filter on the LG WM3170CW Front Load Washing Machine. A backed up drain and filter can lead to problems in the washing machine, such as leaking or damaged tubing. By draining and cleaning the drain filter monthly, these problems can be prevented.

No special tools or skills are necessary for this fast fix, but a few common household items are needed. This includes a shallow tub for the water to drain into and a toothbrush or damp washcloth for cleaning. Before beginning, make sure you have these items and an open space for easy access to the drain filter panel.

TOOLS:

- [Toothbrush](#) (1)
 - [Damp washcloth](#) (1)
 - [Shallow tub](#) (1)
-

Step 1 — How to Drain and Clean the Drain Filter on the LG WM3170CW



- Turn off the washing machine.

Step 2

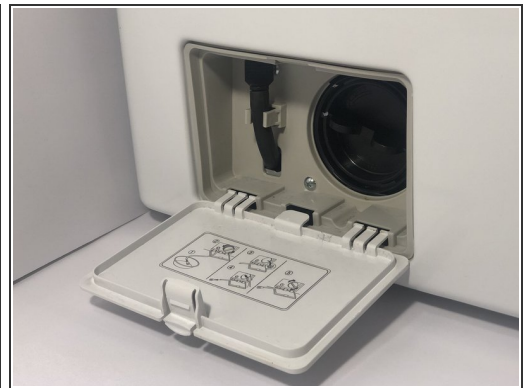

- Open the panel that is located at the bottom left of the washing machine.

Step 3



- Unlatch the draining tube and prepare the shallow tub for draining
 - ⚠ Do not pull on the tube farther than it can go. This can damage the tube.
- Unscrew the plug and drain the water into the tub.
- Once no more water is coming out, plug the tube and place it back in its original position.

Step 4



- Unscrew the filter counterclockwise and remove it.
- Dump out the components in the filter and properly dispose of it.

Step 5



- Using a toothbrush or damp washcloth, gently clean the inside and outside of the filter to remove leftover debris.

Step 6

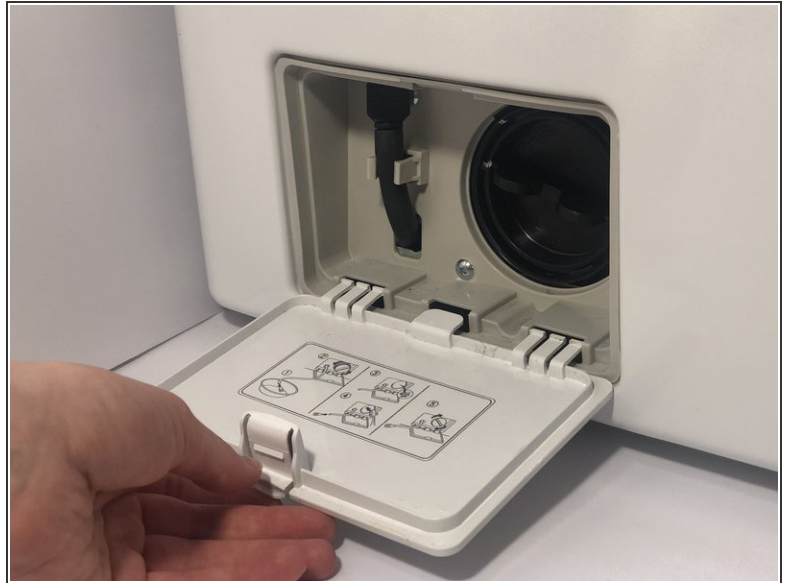

- Screw the filter clockwise back into place.
- Ensure the drain and filter are returned into their original positions and close the panel.

To reassemble your device, follow these instructions in reverse order.