



Free Wheelchair Mission GEN 2 Assembly

This guide contains instructions detailing how to assemble your GEN 2.

Written By: Garrett Goff





TOOLS:

- [10mm Wrench](#) (1)
- [10 mm open-end wrench](#) (1)
- [Socket 19mm](#) (1)
- [19 mm open-end wrench](#) (1)



PARTS:

- [Axle bolt and nut](#) (2)
- [Long Frame bolt and nut](#) (8)
- [Short bolt and nut](#) (2)
- [Short blue tipped bolt and rubber tipped nut](#) (4)
- [Castor](#) (2)
- [Left frame piece](#) (1)
- [Right frame piece](#) (1)
- [Rear wheel](#) (2)
- [Swing-away footrest](#) (2)
- [Air pump with patch kit](#) (1)
- [Crossbar](#) (3)
- [Left push handle](#) (1)
- [Right push handle](#) (1)
- [Left brake](#) (1)
- [Right brake](#) (1)
- [Seat](#) (1)
- [Backrest](#) (1)
- [Seatbelt](#) (1)
- [Calf Strap](#) (1)
- [Cushion](#) (1)

Step 1 — Free Wheelchair Mission GEN 2 Assembly



- Align the crossbar (with the hole in the center) with the screw holes on the bottom of one frame piece.
- Attach the crossbar to the left frame piece with two [2] frame nuts and bolts.
- Repeat on the opposite frame piece.

Step 2



- Align the second crossbar with the holes on the back of the frame.
- ⓘ This crossbar has two square holes on either side.
- Attach the crossbar to the frame using four [4] frame nuts and bolts.

Step 3

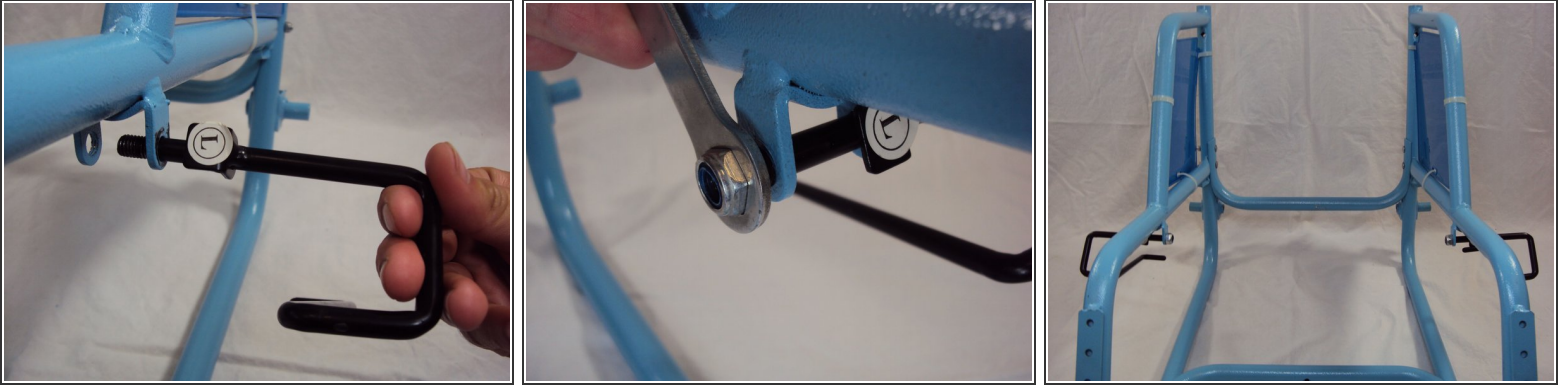

- Align the left (L) frame piece with the brake hole on the left frame piece.
- Insert and tighten using one [1] brake bolt.
- Repeat using the right (R) brake with the right frame piece.

Step 4

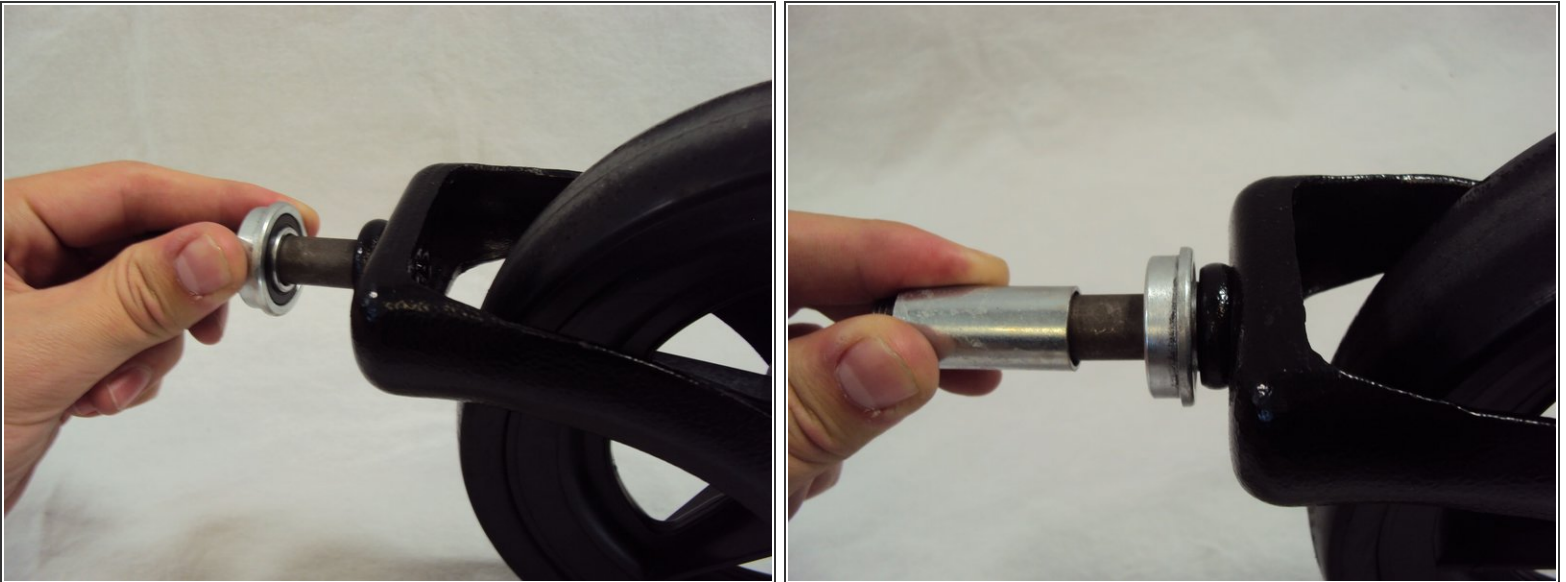

- Slide the ring-shaped piece of one castor bearing onto the axle of one castor.
- Slide the metal tube piece onto the axle of the castor.
- Repeat for the second castor.

Step 5



- Slide another ring shaped bearing piece into the castor hole on the frame.
- Insert the entire castor piece (castor, ring, and tube) into the opposite side of the hole.
- Secure the castor and bearing pieces with a castor bolt.
- Repeat on the opposite side of the frame.

Step 6



- Insert an axle bolt through the center of a rear wheel.
- Insert the axle bolt with wheel into the axle hole on the frame.
- Tighten the axle bolt.
- Secure the wheel with a bolt on the opposite side of the hole.
- Repeat on the opposite side of the frame to attach the other wheel.

Step 7



- Slide each handle into the respective slot on the top of the wheelchair.
- Adjust the handles up or down to your desired height.
- Secure the handles in place with one bolt and nut for each side.

Step 8



- Insert the remaining crossbar between the handles, and align the holes on both sides.
- Secure the crossbar with four [4] blue tipped bolts and rubber tipped nuts (two on each side).

Step 9

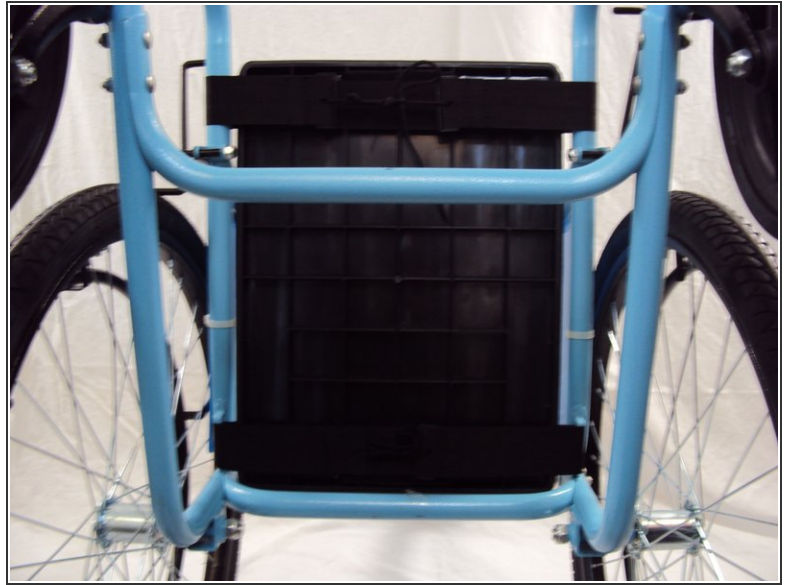

- Orient the plastic seat with the smooth side up.
- ⓘ The rear strap can be attached to the seat in one of three positions in order to accommodate for people of different heights.
- Loop the straps over the bars of the frame on either side.
- Rotate the wheelchair onto its back side.
- Secure the seat by tying each strap together.
- ☑ Make sure that the straps are tied tightly so that the seat does not fall off the wheelchair.

Step 10

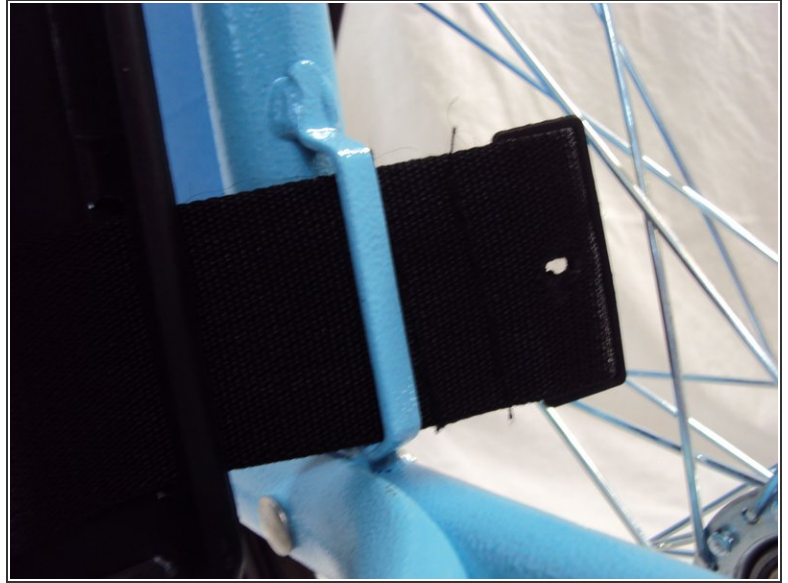

- Reorient the chair so it is upright.
- Place the seat cushion on top of the plastic seat with the angled side in front.

Step 11



- Place the bottom of the backrest against the back of the seat cushion.
- Loop each strap behind the vertical bars of the frame.
- Secure the backrest by tying each strap together.
- ☒ Make sure that the straps are tied tightly so that the backrest does not fall off the wheelchair.

Step 12

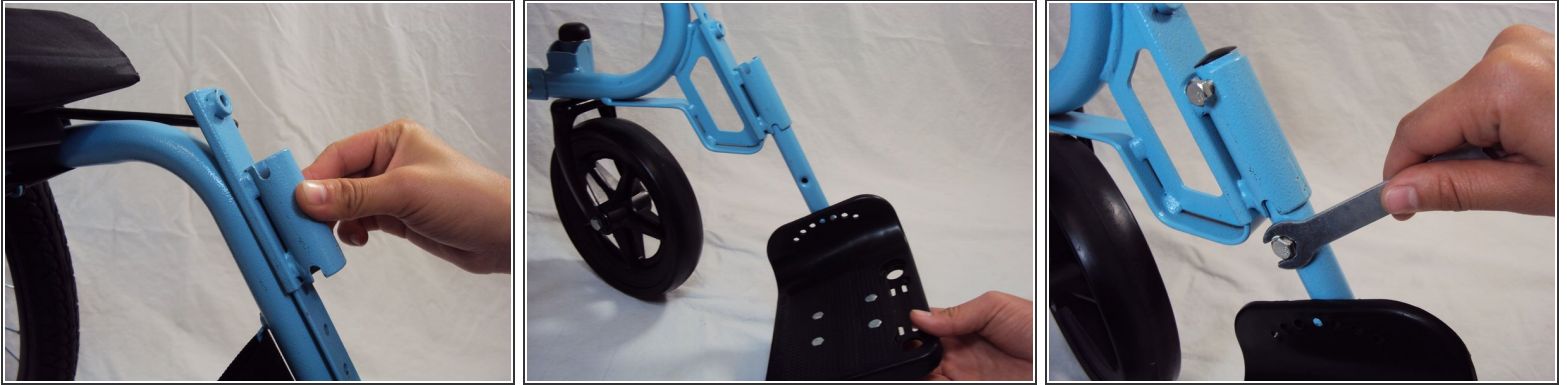

- Slide a footrest socket over the rail located near the front of the seat.
- Insert a footrest through the bottom of the footrest socket.
- Secure the footrest with a bolt above and below the socket.
- Adjust the footrest socket to your desired height.
- Align the socket's bolt with the nearest hole in the rail, and tighten the bolt.
- Repeat this step on the opposite rail.

Step 13



- Adjust the footrest socket to your desired height.
- Align the socket's bolt with the nearest hole in the rail, and tighten the bolt.
- Repeat this step on the opposite rail.

Step 14



- Insert the pump bracket through the lower crossbar.
- Secure the bracket with a rubber tipped nut.
- Place the tire pump in the bracket.

To disassemble your device, follow these instructions in reverse order.